

# Victorian Heritage Database Report

Report generated 05/11/20



1 fulham balmoral horsham rd kanagulk  
front view homestead nov1994



fulham balmoral horsham rd kanagulk  
front verandah nov1994



fulham balmoral horsham rd kanagulk  
meat house nov1980



fulham balmoral horsham rd kanagulk  
woolshed complex feb1980



fulham balmoral horsham rd kanagulk  
overseer's cottage nov1994



fulham balmoral horsham road kanagulk  
shearers shed nov1980

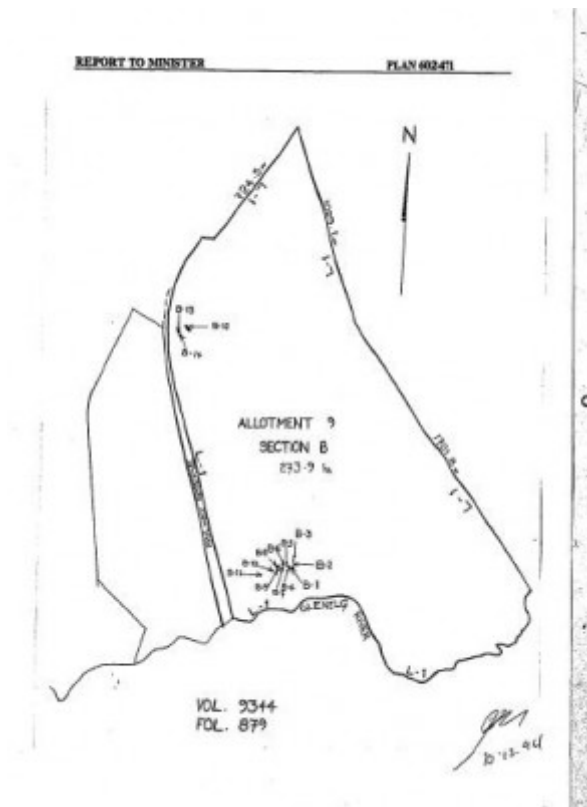

h00476 plan h00476

---

### Location

29 WALCOTT ROAD KANAGULK, HORSHAM RURAL CITY

### Municipality

HORSHAM RURAL CITY

### Level of significance

Registered

### Victorian Heritage Register (VHR) Number

H0476

### Heritage Overlay Numbers

HO23

## VHR Registration

September 10, 1980

## Amendment to Registration

February 23, 1995

## Heritage Listing

Victorian Heritage Register

---

## Statement of Significance

Last updated on - June 17, 1999

What is significant?

Fulham Homestead is a large complex of early farming buildings, built between 1848 and 1861 for George Armytage. The property is a substantially intact pastoral property, altered only during a brief period of occupation as a soldier settlement when a number of the original buildings were demolished.

How is it significant?

Fulham Homestead is of architectural, historic and social significance to Victoria.

Why is it significant?

Fulham Homestead is a rare and essentially intact large complex of early farming structures, of considerable age, some buildings possibly dating back to 1848. The buildings are extraordinary examples of early and simple design. They demonstrate outstanding craftsmanship in the early and skilled use of crude local stone and timber, and later in the manufacture and use of hand made bricks. The main homestead building also demonstrates the rare use of thatch for roofing which is still evident despite recladding in shingles and later still with corrugated iron. The property's extensive farming facilities are expressed by the variety of outbuildings. Of these, many demonstrate a long sequence of usage for their original intention, almost continuously since the time of their construction.

The complex represents a way of life for early and successful pastoralists, particularly in the western District. The Armytage family were leading figure in the development of Victoria's pastoral industry and large landholders throughout the state. The property is also important for its social associations for a brief period following World War 2 in which it was acquired as soldier settlement named Kanagulk, after which the area is named.

Construction dates	1848,
Heritage Act Categories	Registered place,
Hermes Number	609
Property Number	

---

## Extent of Registration

AMENDMENT OF REGISTER OF HISTORIC BUILDINGS

Historic Building No. 476:

Fulham Homestead, Balmoral-Horsham Road, Kanagulk.

(To the extent of:

1. All of the buildings known as Fulham Homestead including the Homestead Building (B1), Original kitchen wing and dining room (B2), Meat house (B3), Servants quarters/Guest wing (B4), Weatherboard cottages (B5), Farm building (B6), Coach house (B7), Stables (B8), Slab animal stalls (B9), Mens quarters (B10), Overseers' cottage (B11), Shearing shed (B12), Shearers quarters (B13), Shearers kitchen (B14), marked on Plan 602471 endorsed by the Chairperson, Historic Buildings Council and held by the Director, Historic Buildings Council.

2. All of the land described as Allotment 9 Section B in Certificate of Title Volume 9344 Folio 879 marked L-1 on Plan 602471 endorsed by Chairperson, Historic Buildings Council and held by the Director, Historic Buildings Council.)

[Victoria Government Gazette No. G7 23 February 1995 pp.412-413]

*This place/object may be included in the Victorian Heritage Register pursuant to the Heritage Act 2017. Check the Victorian Heritage Database, selecting 'Heritage Victoria' as the place source.*

*For further details about Heritage Overlay places, contact the relevant local council or go to Planning Schemes Online <http://planningschemes.dpcd.vic.gov.au/>*