

## DESIGN INTENT

To improve the **public amenity** throughout the precinct with the:

- treatment of well maintained and inviting landscapes
- improved connections to the surrounding community
- clear hierarchy of pedestrian connections and defined vehicle movements
- variety of circulation routes throughout
- designed for inclusivity
- clear wayfinding and interpretive signage

To support principles of **cultural & environmental sustainability** with:

- future plant selection and habitat creation in the park
- diverse collection of plant species relating to the original EVC's
- selection of 'urban' planting palette for localised areas
- consideration of future maintenance requirements and challenges
- material selection for local conditions
- education and engagement with the natural environment through the valuing of the indigenous birds, insects and local fauna
- support the use of sustainably sourced materials and reclaimed materials

To value of the **physical and mental health** of the community through:

- reinforcing the existing 'urban park for all' and providing a broad spectrum of opportunities for both active and recreational pursuits that are multi-generational in character
- supporting art, culture and story telling throughout the park
- the consideration of the principles of CPTED including the provision of open views for safety, seamless access throughout and opportunities to rest and recover

It is with respect that we understand that a detailed oral history exists for the stories and customs of the **traditional owners** of this area. Incorporate active engagement with representatives from the Barengi Gadjin Land Council to reflect the potential interpretation from the **Wotjobaluk, Jaadwa, Jadawajali, Wergaia and Japagulk** families.

## GENERAL GUIDELINES

**Lighting** - to create lighting fit for purpose throughout the park with the objective to extend the use of the site and offer safety, direction, ambience and playful opportunities

**Connectivity/ surveillance** - provision of WiFi, charging stations, CCTV, other

**Paths of travel/circulation** - to provide a variety circuits throughout the precinct. Support connections to local neighbourhood through improved pedestrian/ shared trail passage crossings of surrounding roads. Width of shared trail through precinct to support two passing mobility devices (3000m).

**Furniture** - provision of regularly spaced seats with backs & armrests along path system at least every 100m with additional seating in landscape features and parkour elements. I

**Drinking Fountains** - provided at gathering areas/ main entrances - to be inclusive in design

**Signage/Wayfinding** - directional & interpretative for distance markers and local stories of place

**Art** - incorporation of artistic elements into the layout, colour palette, vertical walling, paving design, structure design, etc

**Shade & shelter** - provision of sheltered areas throughout the park to support a variety of user groups

**Sporting & Play Facilities** - support multi-use, multi-size, multi-purpose facilities - such as adjustable goals, multi-linemarking on court facilities, multi sized swings, social swings, skate park for beginners to advanced, traffic school layout, etc

**BBQ Facilities** - provision of universally accessible BBQ's in two of the gathering areas



Remnant tree Ballarat (interpretive signage & protection)



Royal Park (layers of pathways, gathering, play and activity - City of Melbourne)



Cantilever shelter (Moodie)



Large scale shelter (Trusteel fabrications)



Toilet mural to extend into future detail of vertical walls of skate park (Hannah French)



Interactive Signage/ art interpretation



Skate Park vertical wall treatment (Happy Decay)



Parkour - landscape (Esplanade)



Parkour - equipment (photos courtesy Lark Industries)



DJ Station with connection to mobile phone of users or pre-installed music (Yaip)



Parkour - landscape (photos courtesy Mitchell Robinson)



Playful challenging opportunities - Mouse Wheel - for all ages



Variety of swings for all abilities and ages



Inground trampolines (Adventure +)



Ninja Course or Street equipment (Proludic)



Rock climb wall/ container (Esplanade)



Inclusive Merry-go-round

1 Inclusive Equipment for play



Large birds nest swing for all abilities and ages (Kompan)



Skysurf for all ages - swinging, social interaction, rotating and balancing (Proludic)



Inclusive spinning cup for all abilities and ages (Kompan)



Inclusive long flying fox all abilities and ages (Kompan)



Climbing Mast challenge for all hanging & climbing (Proludic)



Aeroskate (Proludic - slide, meet & balance; playful skate training)



Basketball Goals (Proludic)

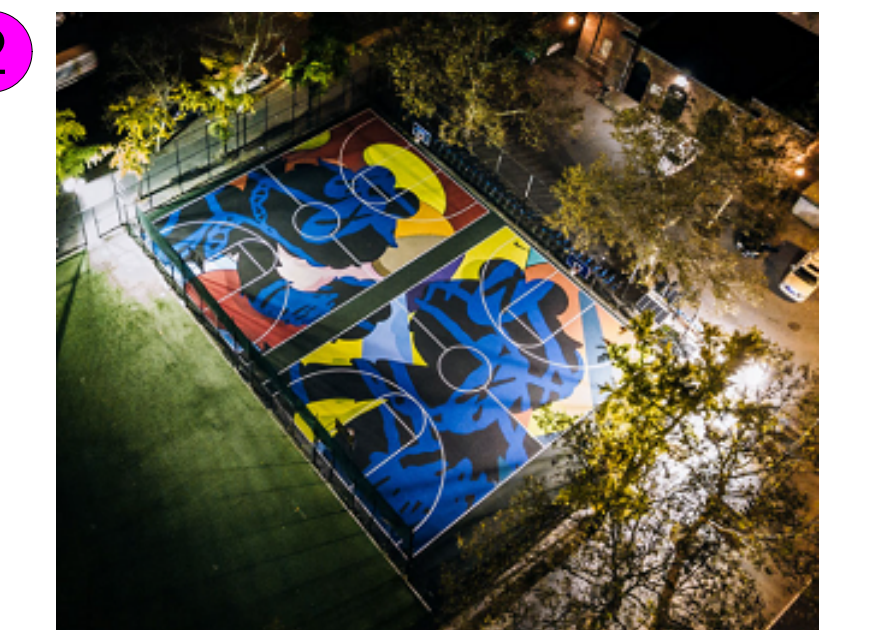

Painted acrylic court (Yellowtrace)

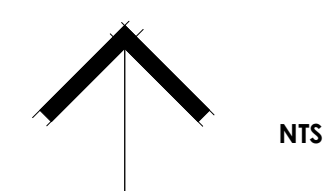

Schematic Landscape Design - Precedent Images

FOR COMMENT

**Horsham Skate Park**

Natimuk Rd HORSHAM

30.09.2022  
PN 225

PO Box 765 HORSHAM VIC 3402  
041 041 2440  
felcity@laimiga.com.au

Note: This is a concept design drawing and not a working drawing. It is not to be used for construction purposes. Levels and dimensions are approximate only. This drawing remains the property of the Landscape Architect. COPYRIGHT LAIMIGA DESIGN STUDIO





# HORSHAM SKATE PARK - URBAN PARK FOR ALL - COMMUNITY, ACTIVITY & CONNECTION

Our vision is that the Hosham Skate Park will provide a range of opportunities and experiences for people to have fun and be physically active.  
The park will be a central meeting place for people of different ages and interest; a place we love to go to, spend time in or pass through.

- Landscaping**  
Removal of existing toilet facilities and infrastructure. Make good landscape. Investigate future connection to landuse and activity north of the focus area. Incorporate power & water supply for event set-up
- Existing vegetation**  
Identify, protect and nurture existing Grey Box specimens - celebrate and communicate their story, age, connection to the landscape, place in the ecosystem through potential artistic interpretation
- Dirt Track & jumps**  
Groom and regrade track in consultation with with CRG and consultant/contractor skilled in best practice grooming and trail re-creation. Surround track with shade trees and seats/ platforms for viewing with additional shelter on existing concrete slab with seating and lookout
- Water Storage Tank / Gathering area**  
Opportunity to provide structure over storage tank with floating floor with opportunities for stage, shade, raised planter boxes. Provided a span is achievable and a floating floor can be engineered to protect existing storage tank infrastructure with no direct or indirect load. Potential to locate relocatable screen for projections/ movies (combined into pump shelter extension), seating tables, lighting. WiFi, phone charging stations, power outlets and CCTV
- Skate Park Facilities - existing**  
Improve lighting of whole site, consider the feasibility of CCTV, review location of centrally located wall, review coping detail, investigate ambulance access and access to bowl with local authorities, art/ colour on vertical surfaces, extend and review pump house height and use for projections
- Skate Park Facilities - proposed stage 1**  
Extend footprint of skate park to include freestyle skate elements (platforms, rocks, slabs / parkour elements with path connection to dirt jumps) - surface to be sealed concrete. Review feasibility for small/ junior shallow bowl/ half bowl similar to Dimboola Skate Park.
- Gathering**  
Provide opportunities for gathering, viewing of skate area, seating, picnic setting, natural seating options, irrigated lawn, shade, art and shade trees. Ensure open space for first aid officers and event officials - provide water and power
- Secondary path connections**  
Develop a variety of walking/ shared trail connections. Opportunity for traffic elements, mounds and seating throughout
- Landscaping**  
Develop landscaping areas with additional trees, diversity in plant selection, irrigated lawn areas and natural elements for seating and play. Consideration to sensory qualities of
- Fitness & Ninja**  
Extend diversity of existing equipment to support gathering, connection, multi-generational and Ninja fitness elements



- Hard surface multipurpose court**  
Re-surfacing of existing carpark to support multi-use linemarking (basketball/ 4 square) and carparking for CFA training activities. Ensure court can be used as a staging site for events held in northern section of park
- Shared trail**  
Minimum 2.5-3m wide sealed shared trail to support high use and commuter users along with recreational user groups. Implement street tree strategy to provide additional shade along both sides of trail
- Pump Track**  
Reinvigorate existing landscape with pump track design & constructed with specialist consultant with CRG engagement
- Traffic Engineering Solutions**  
Opportunities for safe pedestrian crossing points to support existing pedestrian movement patterns
- Multi-generational Play space**  
Support a diversity of user groups to engage with the play space. Encourage inclusive connections, variety of play opportunities, gathering opportunities, shade, landscaping and quiet areas
- Toilet Facilities**  
Integrate toilet facilities into surrounding with bike racks, GWM water fountain inclusive design with dog bowl, waste management. Consider future opportunities for 'Changing Places' compatibility.
- Gathering**  
Low key gathering space with art, seating, wayfinding, gopher charging station, connection to skate and infrastructure. Provide clear separation between skate park and shared trail to reduce conflict of movement.
- Entrances**  
Opportunities for a journey of movement into the skate park precinct - variety of entrances into different areas to improve connectivity and choice
- Hardstand**  
Opportunity for power, hardstand and water outlet for food van parking. Keeping views open, access for pedestrians from south. Provide incidental seating opportunities (rocks/ deck platforms) for outdoor cafe
- Existing Carpark**  
Potential canvas for street art and overflow area for festival/ carnival/ competition days
- Art**  
Investigate potential art integration throughout the site - working with the existing artwork on the toilets and linking to the synthetic surface under the play equipment, vertical walls in the skate park, concrete paving design/ detailing, seating, Horsham photo wall, acrylic basketball court design, etc to communicate a story, capture the energy of the usergroups and provide a playful whimsy for exploration for all ages

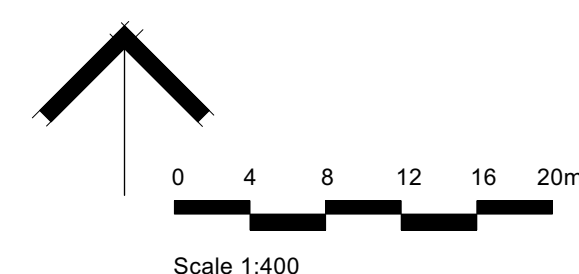

Schematic Landscape Design - Concept Layout

FOR COMMENT

**Horsham Skate Park**

Natimuk Rd HORSHAM

30.09.2022  
PN 225

PO Box 765 HORSHAM VIC 3402  
041 041 2440  
felicity@laimiga.com.au  
Note: This is a concept design drawing and not a working drawing. It is not to be used for construction purposes. Levels and dimensions are approximate only. This drawing remains the property of the Landscape Architect. COPYRIGHT LAIMIGA DESIGN STUDIO









# Community Engagement Report

HORSHAM YOUTH PARK ENTERPRISE (HYPE)

Known as: HORSHAM SKATE PARK -

DEVELOPMENT OF CONCEPT PLAN

DECEMBER 2022



PURPOSE OF ENGAGEMENT REPORT .....	3
BACKGROUND .....	3
FOCUS AREA .....	4
PUBLIC PARTICIPATION GOAL .....	4
IAP2 LEVEL .....	4
OUR PROMISE .....	4
ESTABLISHMENT OF COMMUNITY REFERENCE GROUP .....	4
VISION ESTABLISHED BY THE CRG .....	5
PROJECT TIMELINE .....	5
ENGAGEMENT TOOLS .....	5
WHAT FEEDBACK WAS RECEIVED? .....	6
HOW WAS THE FEEDBACK MANAGED? .....	6
WHAT DID PEOPLE LIKE MOST ABOUT THE DRAFT PLAN .....	7
WHAT PARTS OF THE DRAFT PLAN DID PEOPLE WANT CHANGED / ADDED? .....	7
HOW WAS THE FEEDBACK EVALUATED? .....	7
HOW DID THE FEEDBACK INFLUENCE THE FINAL DESIGN? .....	7
WHAT ARE THE NEXT STEPS IN THE ENGAGEMENT PROCESS? .....	8
WHAT IS THE ROLE OF THE CRG? .....	8



## PURPOSE OF ENGAGEMENT REPORT

This report summarises the engagement process undertaken and feedback received in the development of the draft concept plan for upgrades to Horsham Youth Park Enterprise (HYPE) known locally as the Horsham Skate Park.

## BACKGROUND

The Skate Park was opened 4 May 2013 and provided an alternative skate board facility to the skate bowl located along Eastgate Drive.

The park is a site of regular activity by people using scooters, skate boards and bikes. The depth and design of the concrete bowl at the skate park limit usage for novice/learner skaters. Currently, the popularity of skate boarding in Horsham has declined and the area is used by people using scooters.

The Skate Park is classified as a regional park (HRCC 2019 Open Space Strategy) but an audit of the park identified a gap in the provision of essential infrastructure:

- accessible toilet facilities (since addressed)
- Open areas for informal play, natural play, irrigated grass, landscaping
- Accessible equipment, pathways, Universal Design
- Structured shade / shelter, picnic tables, BBQs
- Signage – wayfinding and history, public art

The dirt jumps have not been regularly maintained.

A Gender Impact Assessment, (GIA) required under the Gender Equity Act 2020, identified that the main demographic currently using the park are males aged 4-30 years and that design changes are required to make the park inclusive and accessible to a broader range of people.

There are perceived safety issues (associated with the limited demographic and perception of territory) at the skate park and vandalism is occurring at the site.

A review of the current usage of the park and identification of opportunities to improve the park resulted in the establishment of a Community Reference Group (CRG) and the development of a concept plan for upgrades to the park.



## FOCUS AREA



The focus area is shown (left).

The area is bounded by Natimuk Rd (south) and Park Drive (east).

The site is on Crown land, with Horsham Rural City Council (HRCC) being the Committee of Management for the site.

Crown land to the west of the park is licensed to the Horsham and District Racing Club.

An underground water tank and pump shed (circled in yellow) are located in the middle of the skate park concrete area.

An observation tower (circled in yellow) identifies the potential location of a relocated western fence

## PUBLIC PARTICIPATION GOAL

The goal of the community consultation was to:

- Obtain feedback regarding the draft concept plan to ensure the plan satisfied both a community vision for the Park and the needs of the broader community.

## IAP2 LEVEL

Community – Consult

Community Reference Group – Collaborate

## OUR PROMISE

To the community - We will keep you informed, listen to and acknowledge concerns and aspirations and provide feedback on how public input influenced the decision.

To the CRG - We will work with you to ensure that your concerns and aspirations are directly reflected in the alternatives developed and provide feedback on how public input influenced the decision.

## ESTABLISHMENT OF COMMUNITY REFERENCE GROUP

A Community Reference Group (CRG) was formed in August 2021.

The CRG is comprised of the following members:

- Skaters and people who use scooters at the Park (x2)



- Bike riders (Dirt jumps and concrete area) (x2)
- Senior adults (x1)
- Disability sector (x1)
- Community (1)
- HRCC Youth Council (x1)

Two HRCC officers from the Recreation and Open Space Planning (ROSP) team attended CRG meetings.

The CRG met regularly from August 2021 until September 2022.

Meetings were held in person at the Park Drive netball and CFA facility and at the Civic Centre, Roberts Avenue, Horsham.

Meetings were generally of a 1.5 hour duration.

## VISION ESTABLISHED BY THE CRG

*Our vision is that the Horsham Skate Park will provide a range of opportunities and experiences for people to have fun and be physically active.*

*The Park will be a central meeting place for people of different ages, abilities and interests; a place we love to go to, spend time in or pass through.*

## PROJECT TIMELINE

August 2021	Project commenced with the formation of the CRG
August – November 2021	Project planning with CRG (Includes stakeholder consultation undertaken by HRCC officers)
June 2022	CRG endorsement of draft concept plan
July 2022	Report to Council seeking approval to release the draft concept plan for community feedback
July – August 2022	Community engagement
August 2022	Feedback grouped and themed
August 2022	Community feedback reviewed by CRG and amendments made
August 2022	Amended plan endorsed by CRG
August 2022	Amended plan presented to the community via HRCC webpage
February 2023	Plan presented to Council for adoption

## ENGAGEMENT TOOLS

A combination of passive and interactive engagement tools were used.

Passive: Weekly print media (local newspapers), HRCC webpage, HRCC e-newsletter, HRCC Facebook posts, HRCC Active e-newsletter, Core flute displayed at the Skate Park and in the reception area of the Civic Centre. Printed surveys were also available at the Civic Centre.

Interactive: Attendance at Horsham Plaza, (x2) Skate Park - BBQ and on-site meetings (x5) Horsham College (x4) Haven market, and targeted stakeholder meetings.



Note: The process of collecting community input commenced before the CRG was established and continued throughout the development of the concept plan. Initial community input (from the HRCC Youth Council, Skate Park users and others) provided a framework for design elements to be considered by the CRG.

Targeted stakeholder meetings were held with:

- Wimmera Catchment Management Authority
- Older Adults' Advisory Committee
- Wimmera Health Care Group
- Country Fire Authority
- Victorian Police
- Community Inclusion
- Church of Christ – seniors' group
- Horsham and District Racing Club
- Harness Racing Club
- HRCC Youth Council (3 meetings)
- HRCC Youth Group – new arrivals
- Goolum Goolum Aboriginal Cooperative
- HRCC Parks and Gardens' staff
- HRCC Asset team
- Strategic Planning Coordinator - HRCC
- Parks and Gardens' (Acting) Coordinator – HRCC

Feedback from groups was captured in different ways: completion of individual surveys, feedback from a group collected as a single survey response, and in a number of cases, people chose to receive the information, make verbal comments but not complete a survey. Comments were captured as survey responses, entered by ROSP officers.

Notes were taken at each stakeholder meeting.

## WHAT FEEDBACK WAS RECEIVED?

Four hundred and thirty-eight (438) survey responses were received. The actual number of responses is higher (see comment above re: grouped responses).

Many people (201) chose to complete paper-based surveys and 236 people opted to complete surveys on-line, either via the HRCC webpage or via a QR code directing them to the survey on the HRCC webpage.

The draft plan for upgrades to the park was overwhelmingly supported with only three negative comments. Two comments supported the detail of the plan but wanted changes to happen immediately and a third respondent questioned the value of improving the park.

## HOW WAS THE FEEDBACK MANAGED?

Survey data was collected via Microsoft Forms with a summary of short form (closed questions) attached to this report.



Feedback (open questions generating long-form comments were collected via both the electronic survey and the printed surveys) and was transferred to a spreadsheet and then grouped according to themes that emerged in frequency (Example: shade, seating, play elements).

All original survey documents, both paper-based and electronic, have been filed on the HRCC data management system.

## WHAT DID PEOPLE LIKE MOST ABOUT THE DRAFT PLAN

People confirmed the importance of:

- Trees, shade, shelter from wind and rain and different types of seating throughout the area
- Play and activity equipment that is appropriate for a variety of ages and abilities with a request that different types of activities be provided in the park
- Placement of seating to enable supervision of activities
- Provision of amenities such as BBQs and gathering areas, with drinking fountains across the park
- Ensuring connected pathways for movement to and through the park
- Upgrading existing facilities – skate park (bowl) and dirt jumps
- Creation of learner activities – jumps, skate bowl
- Integration of art throughout the park and colour on vertical surfaces
- Nature-based play that is accessible to people of different ages and abilities
- Careful selection and placement of plants and landscaping and grassed areas.

## WHAT PARTS OF THE DRAFT PLAN DID PEOPLE WANT CHANGED / ADDED?

- Provision of more shade and seating options throughout the park
- Provision of supporting infrastructure – an outside shower, wifi and phone charging points, repair station for tyres, storage cupboard for cleaning the skate bowl

## HOW WAS THE FEEDBACK EVALUATED?

Feedback was considered against three forms of criteria, including the:

1. Vision developed by the CRG
2. Victorian Urban Design guidelines
3. Open Space Strategy (HRCC)

## HOW DID THE FEEDBACK INFLUENCE THE FINAL DESIGN?

Feedback that was consistent with the evaluation criteria was included in the amended concept plan.

In most cases, feedback reinforced existing elements of the draft plan and was 'Noted' by the CRG; or additional notes were added in the explanatory sections of the concept plan for inclusion when detailed design occurs.



Feedback specifically incorporated into the revised concept plan included:

- Additional seating and shade options throughout, including the addition of a second shade structure over the concreted area
- Inclusion of an outdoor shower and nature play area

Following the evaluation process, the draft plan was amended, endorsed by the CRG and placed on the HRCC website for a four week period. A description of the feedback process and themes identified by the community was also placed on the HRCC website.

No additional feedback was received during the four week display.

## WHAT ARE THE NEXT STEPS IN THE ENGAGEMENT PROCESS?

The engagement process for this stage of the project is complete.

When detailed construction drawings are developed they will be shared via the HRCC webpage.

## WHAT IS THE CURRENT ROLE OF THE CRG?

The role of the CRG for this stage of the project will be completed when the concept plan has been presented to Council at a Council Briefing.

The CRG will be notified of Council's decision regarding the recommendation to endorse the concept plan for upgrades to the park.

The CRG has worked collaboratively throughout the project to understand site constraints, work within the defined scope of the project and identify design elements consistent with a shared vision for improvements to the community.

The commitment of members of the CRG is greatly appreciated and the model confirms the value of working closely with the community when undertaking complex community asset planning.

**Mandy Kirsopp**  
**January 2023**